

For Residential and Commercial Applications

Job Name _____ Contractor _____
Job Location _____ Approval _____
Engineer _____ Contractor's P.O. No. _____
Approval _____ Representative _____

Series

C8174 Series

Swing Nozzle

Sizes:

6" to 16" Swing Nozzle

Features & Benefits:

- Easy to use and fix
- With stream regulator outlet
- Fits all Aluids swivel outlet faucets
- The faucet is chrome-plated for optimal durability
- One Year Warranty

Product Compliance:

California Proposition 65

Performance Data:

Pressure: 20-125 PSI

Temperature: 40° to 140° F

Aerators:

Standard Aerator	Suffix	Vandal Resistant Aerator	Suffix
<input type="checkbox"/> 0.20 GPM	E1	<input type="checkbox"/> 0.35 GPM	G1
<input type="checkbox"/> 0.50 GPM	E2	<input type="checkbox"/> 0.50 GPM	G2
<input type="checkbox"/> 1.00 GPM	E3	<input type="checkbox"/> 1.00 GPM	G3
<input type="checkbox"/> 1.50 GPM	E4	<input type="checkbox"/> 1.50 GPM	G4
<input type="checkbox"/> 1.80 GPM	E5		

Laminar Flow Outlet	Suffix	Vandal Resistant Laminar Flow Outlet	Suffix
<input type="checkbox"/> 0.50 GPM	F1	<input type="checkbox"/> 0.35 GPM	H1
<input type="checkbox"/> 1.50 GPM	F2	<input type="checkbox"/> 0.50 GPM	H2
		<input type="checkbox"/> 1.00 GPM	H3
		<input type="checkbox"/> 1.50 GPM	H4

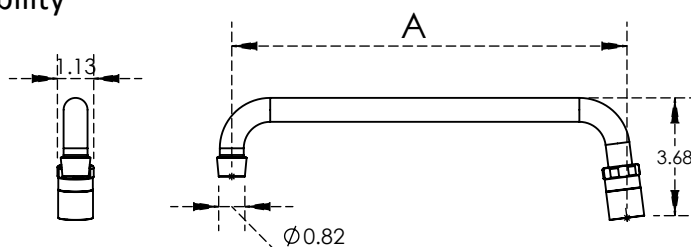
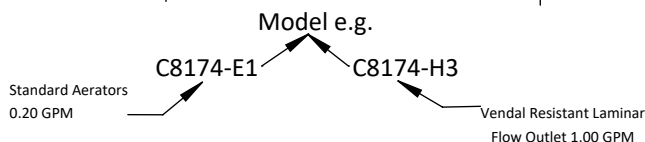

Dimensions - Weights

MODEL	DIMENSIONS		WEIGHT	
	A			
	in	mm	lbs.	kgs
C8174	6"	152	0.47	0.215
C8175	8"	203	0.54	0.248
C8176	10"	254	0.60	0.273
C8133	12"	304	0.61	0.278
C8177	14"	355	0.70	0.322
C8178	16"	406	0.76	0.346

NOTICE

The information contained herein is not intended to replace the full product installation and safety information available or the experience of a trained product installer. You are required to thoroughly read all installation instructions and product safety information before beginning the installation of this product.

ALUIDS

US & Canada :- +1-678 666 2001

Krome product Specifications in U.S. customary units and metric are approximate and are provided for reference only. For precise measurements, please contact Krome Technical Service. Krome reserves the right to change or modify product design, construction, specifications, or materials without prior notice and without incurring any obligation to make such changes and modifications on Krome products previously or subsequently sold. For most updated specification sheet, go to www.aluids.com