

For Residential and Commercial Applications

Job Name _____
 Job Location _____
 Engineer _____
 Approval _____

Contractor _____
 Approval _____
 Contractor's P.O. No. _____
 Representative _____

Series

C8863 Series

Ecoline Wall Mount Grab Bar with concealed screws, Stainless Steels

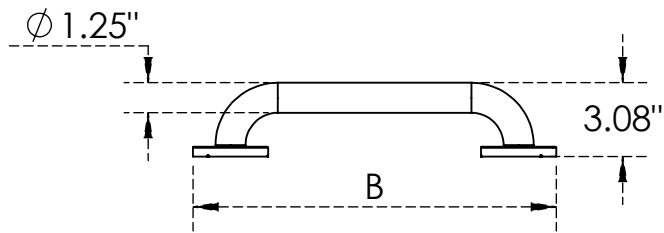
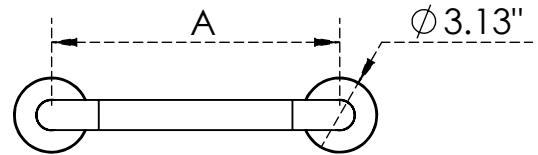

Dimensions - Weights

Sizes:

9", 12", 18"
 24", 36", 48"

Features & Benefits:

- Secure Mount design allows for easy, secure installation at any angle.
- It helps to mitigate slips and falls.
- 1-1/4 inches diameter pipe brushed finish for better grip.
- Heavy duty grab bar with **18 gauge** tubing.
- Weight capacity of up to 400 lbs.
- Complies with ADA specifications.
- Available from 9" to 48".

MODEL	SIZE	DIMENSIONS				WEIGHT lbs.
		A		B		
	in.	in.	mm	in.	mm	
Ecoline Wall Mount Grab Bars: Polished Chrome						
C8863-CP	9"	9"	229	12.13"	308	1.20
C8864-CP	12"	12"	305	15.13"	384	1.29
C8865-CP	18"	18"	457	21.13"	537	1.61
C8866-CP	24"	24"	610	27.13"	689	1.95
C8867-CP	36"	36"	914	39.13"	994	2.57
C8868-CP	48"	48"	1219	51.13"	1299	3.20
Ecoline Wall Mount Grab Bars: Vibrant Stainless						
C8863-VS	9"	9"	229	12.13"	308	1.20
C8864-VS	12"	12"	305	15.13"	384	1.29
C8865-VS	18"	18"	457	21.13"	537	1.61
C8866-VS	24"	24"	610	27.13"	689	1.95
C8867-VS	36"	36"	914	39.13"	994	2.57
C8868-VS	48"	48"	1219	51.13"	1299	3.20

NOTICE

The information contained herein is not intended to replace the full product installation and safety information available or the experience of a trained product installer. You are required to thoroughly read all installation instructions and product safety information before beginning the installation of this product.

Models:

C8863-CP Series

Ecoline Wall Mount Grab Bar Polished Chrome

C8863-VS Series

Ecoline Wall Mount Grab Bar Vibrant Stainless



US & Canada :- +1-678 666 2001

Krome product Specifications in U.S. customary units and metric are approximate and are provided for reference only. For precise measurements, please contact Krome Technical Service. Krome reserves the right to change or modify product design, construction, specifications, or materials without prior notice and without incurring any obligation to make such changes and modifications on Krome products previously or subsequently sold. For most updated specification sheet, go to www.aluids.com