

## For Residential and Commercial Applications

Job Name \_\_\_\_\_ Contractor \_\_\_\_\_  
Job Location \_\_\_\_\_ Approval \_\_\_\_\_  
Engineer \_\_\_\_\_ Contractor's P.O. No. \_\_\_\_\_  
Approval \_\_\_\_\_ Representative \_\_\_\_\_

### Series:

### Wall Mounted Service Sink Faucet with 8" Centre and Lever Handle C8908

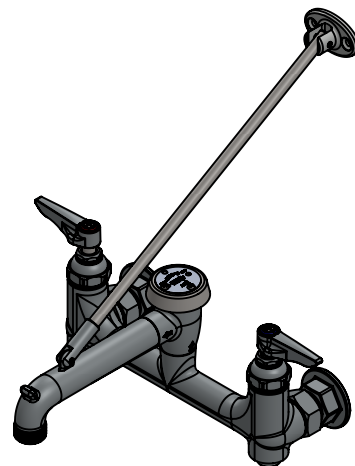
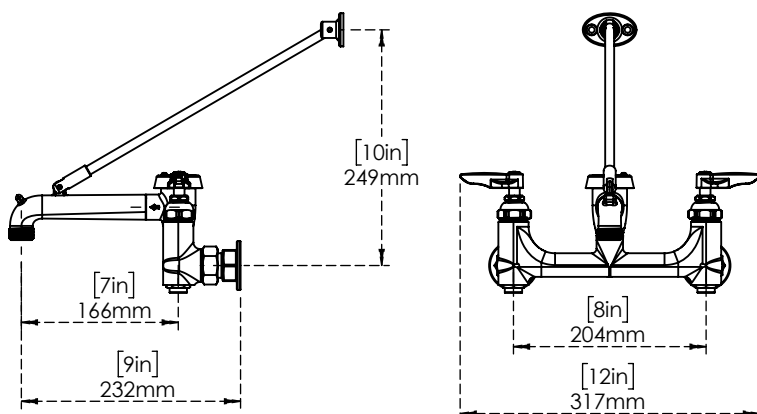

### Features & Benefits:

- 8" Wall mount mixing faucet with Vacuum breaker
- Quarter-turn hot and cold cartridges with spring checks
- Upper support rod for rigid support
- Material: Rough chrome plated brass body & spout

### Product Compliance:

- California proposition 65

**Warranty:** One Year (Limited)

### Performance Data:

- Pressure: 20 - 125 psi [1.38 - 8.62 bar]
- Temperature: 40° F - 140° F [4.44 C - 60 C]
- Flow rate: : Free Flow

### NOTICE

The information contained herein is not intended to replace the full product installation and safety information available or the experience of a trained product installer. You are required to thoroughly read all installation instructions and product safety information before beginning the installation of this product.



ALUIDS

US & Canada :- +1-678 666 2001

Krome product Specifications in U.S. customary units and metric are approximate and are provided for reference only. For precise measurements, please contact Krome Technical Service. Krome reserves the right to change or modify product design, construction, specifications, or materials without prior notice and without incurring any obligation to make such changes and modifications on Krome products previously or subsequently sold. For most updated specification sheet, go to